

Continuous Light Lightbar 130 LED

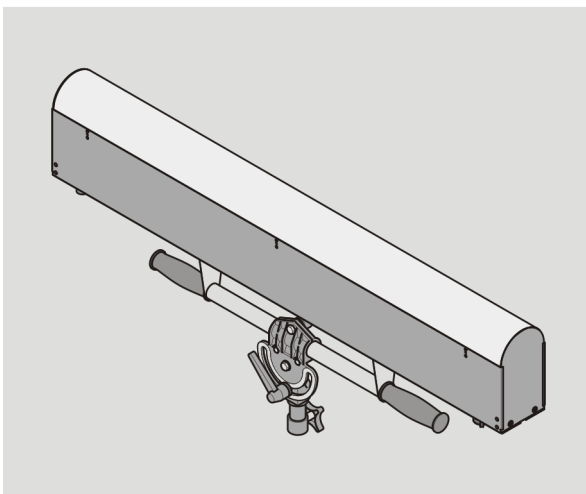

User manual

Translation of the original German user manual

Doc. no. 900.0512.00

Version: 01/2018

Contents

Information about this manual and about the manufacturer.....	4
Keeping this manual on hand	4
Design features in the text	4
Design features in the figures	4
Copyright	5
Manufacturer's address.....	5
Safety.....	6
Intended use	6
Fundamental safety information	6
Prevention of equipment damage and malfunctions.....	7
Design features of warning notices	8
Design features of equipment or property damage information.....	8
Description	9
Overview of scope of delivery	9
Overview of device	10
Overview of swivel head.....	11
Task and function.....	12
Type plate	13
Technical data.....	14
Unpacking the device and checking the scope of delivery.....	15
Commissioning the device	16
Mounting and removing components of the device.....	17
Connecting and disconnecting the mains cable	17
Mounting the device on/removing it from a stand	19
Connecting the device to and removing it from the DMX system.....	20
Rotating and tilting the device.....	22
Operating the device.....	23
Activating and deactivating the device.....	23

Adjusting settings on the device	24
Transporting and storing the device.....	38
Servicing the device	39
Caring for and cleaning the device	39
Replacing a defective fuse	40
Disposing of the device and packaging	42
In Germany	42
Outside of Germany	42
Accessories.....	43
Warranty provisions.....	44
In Germany	44
Outside of Germany	44
Limitation of liability	45
Returning a product to Customer Service.....	46

Information about this manual and about the manufacturer

These instructions will help you to use the “Lightbar 130 LED” continuous light safely. The “Lightbar 130 LED” continuous light is called “device” for short in the following text.

Keeping this manual on hand

This manual is part of the device.

- Always keep this manual together with the device.
- Provide this manual when selling the device or passing it on in another manner.

Design features in the text

Various elements of this manual are provided with specific design features. This allows you to easily differentiate between the following elements:

Normal text

- Action
 - Bullet points

ELEMENTS ON THE DISPLAY

-  Tips contain additional information, e.g. special information on the device.

Design features in the figures

If elements are referred to in a key or in the body of the text, then they are provided with a number (1).

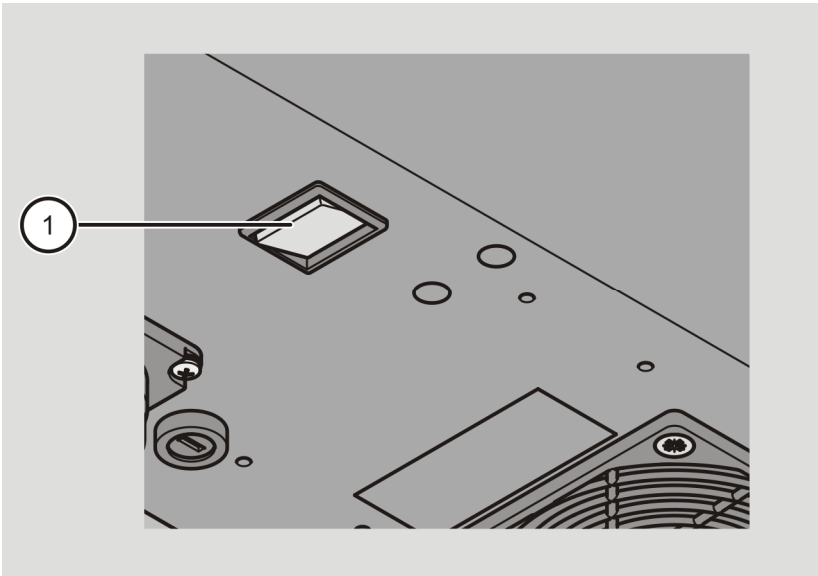

Copyright

This manual contains information that is subject to copyright. Without the prior written permission of Hensel-Visit GmbH & Co. KG, this manual shall not be copied, printed, filmed, processed, reproduced or distributed in any form, in full or in excerpts.

©Hensel-Visit GmbH & Co. KG
All rights reserved.

Manufacturer's address

Hensel-Visit GmbH & Co. KG
Robert-Bunsen-Str. 3
97076 Würzburg
Phone: +49-931-27881-0
Fax: +49-931-27881-50
E-mail: info@hensel.de
URL: www.hensel.de

Safety

The device has been built according to state-of-the-art technology and recognized safety-related regulations. During work with and on the device, however, residual risk remains, which could present a danger to life and limb. For this reason, the following safety information is to be observed and followed.

Intended use

The device is used for illuminating indoor photography and video-recording.

To use this device correctly, it is essential to read and understand this manual, as well as observe and follow all information in this manual, especially the safety information. In addition, the safety information and all other information in the manuals of the cameras used must also be observed. Any other use will be deemed improper use and will invalidate the warranty and liability claims.

Fundamental safety information

Prevention of serious injuries or death from electric shock

Improper work on the device can lead to an electric shock.

- Only connect the device to a power mains with an intact protective conductor.
- Only use plugs with contacts in perfect condition.
- Protect the device from moisture.
- Never use a wet device.
- Do not open the housing.
- Where possible, avoid laying the cable on the ground. If laying on the ground cannot be avoided, make sure the cables are not damaged by vehicles or ladders.
- Regularly clean the outside of the device with a dry cloth.
- Have damaged cables and the device replaced immediately by the authorized customer service only.

Prevention of the risk of burns

Heat is generated during the operation of the device. If the ventilation openings are covered the device can become hot, resulting in burns in case of contact with the skin.

- Make sure the ventilation slots are not covered during operation.

Prevention of equipment damage and malfunctions

Prevention of equipment damage due to fogging

Fogging can occur due to a sudden temperature change, e.g. in a new environment.

- Always let the device acclimatize before use in a new environment.

Prevention of equipment damage due to rain, vapors, frost, heat, humidity and dust

Rain, vapors, frost, heat, humidity and dust can damage the device.

- Protect the device against dripping and spraying water (e.g. rain) or vapors.
- Protect the device against frost, heat and high humidity.
- Do not place containers of liquids on the device.
- Make sure that neither the device nor its components are standing or lying on wet ground.
- Do not store the device in locations exposed to heat or moisture.
- Cover the device with suitable dust protection when it is not in operation.



Prevention of equipment damage when using external products

The use of the device in combination with external products can lead to equipment damage.

- Use the device only with accessories and original spare parts recommended by the manufacturer.

Design features of warning notices

This user manual contains the following safety information:

 CAUTION	
	Notices with the word CAUTION warn about a situation that could lead to light or medium-scale injuries.

Design features of equipment or property damage information

IMPORTANT!	
	This information warns against a situation that can lead to equipment or property damage.

Description

Overview of scope of delivery

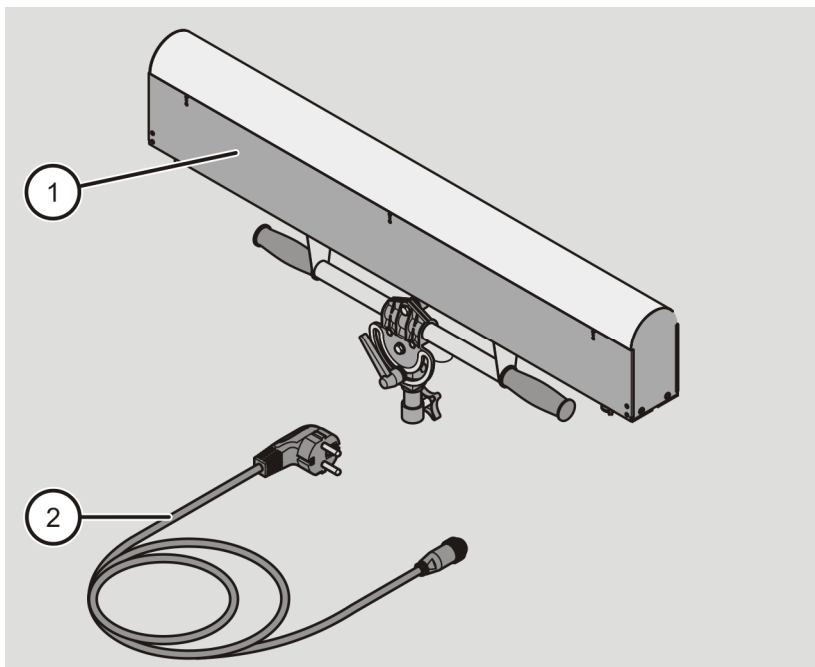

No.	Designation
1	Device
2	Mains cable (country-specific, shown as an example)

Overview of device

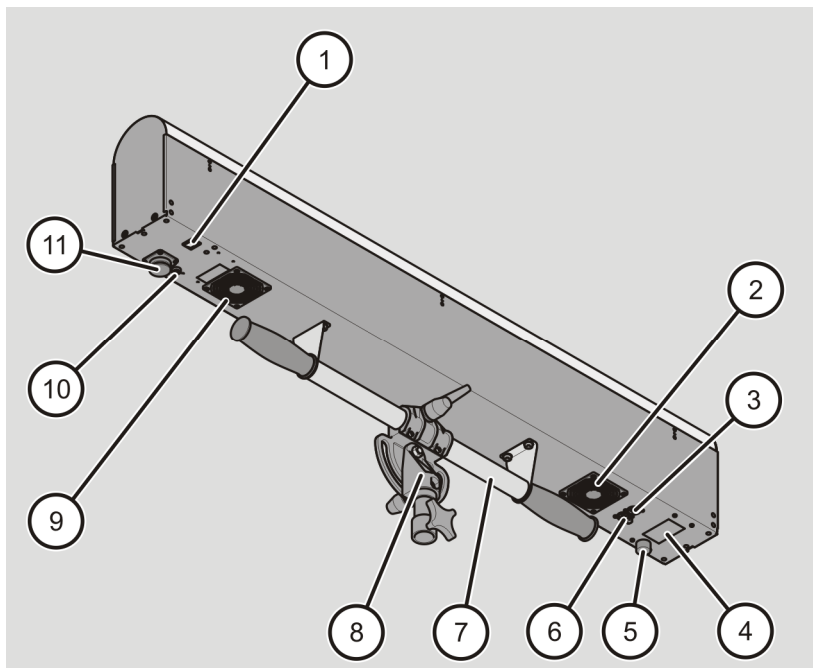

No.	Designation
1	Main switch
2	Ventilation opening
3	Connection socket for 5-pin DMX plug (input)
4	Display
5	Rotary switch and button for selecting the parameters and changing the values
6	Connection socket for 5-pin DMX plug (output)
7	Stand holder
8	Swivel head
9	Ventilation opening

10	Fuse holder
11	Mains socket (13-pin round plug)

Overview of swivel head

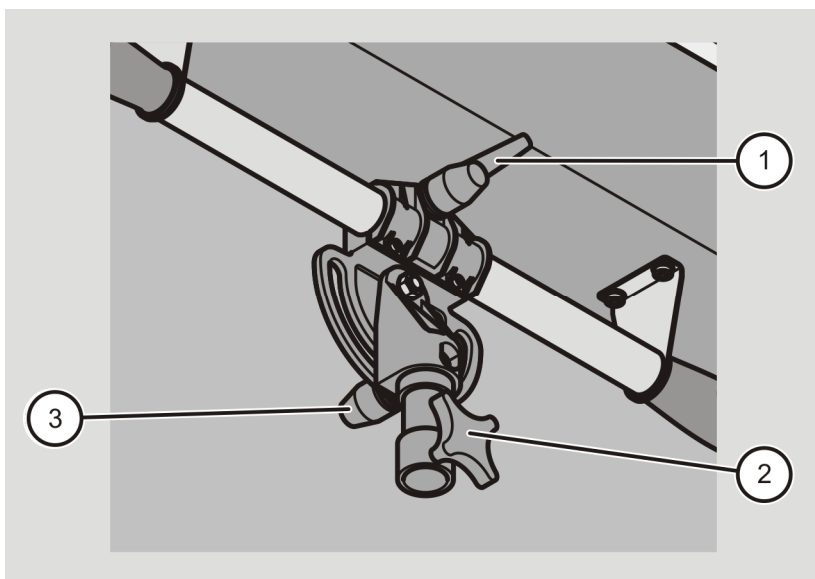

No.	Designation
1	Locking lever for fastening the swivel head
2	Knurled screw for stand adapter
3	Locking lever for tilting

Task and function

The device is used for illuminating indoor photography and video-recording. It can be operated on the mains and attached to a stand.

The device has an LED output of 200 W. The light intensity of 20,000 lm corresponds to a 2,000 W model lamp in a comparable light source. The energy can be adjusted across an energy range of 9 f-stops (in 1/10 f-stop increments).

The color temperature can be set in 50 K increments from 2,700 to 6,500 K. The f-stop and color temperature can be set separately of each other. A color rendering index of 95 at 5,500 K and even 97 at 3,400 K guarantees optimum color rendering of skin tones for images where color tone is critical.

The settings on the device can be made using the rotary switch.

The device can be actuated using the DMX system. The DMX menu can be used if the DMX plug is connected to the device. DMX addresses can be set in the DMX menu. The f-stop and color temperature are set on the DMX console and can be displayed in the DMX menu.

The temperature of the LED is monitored by a temperature sensor. If the temperature is too high, the output is reduced to 10%. After cooling down, the output returns to the last value saved.

Type plate

The type plate is attached to the housing. You will find the following information on the type plate:

- Manufacturer name
- Name of the model
- Code number
- CE marking
- Symbol for environmentally sound disposal
- Country of manufacturing

Technical data

Device type	Lightbar 130 LED
Article number	9121254
Energy range	9 f-stops, 1/10 increments
Illuminant	200 W LED
Illuminant operating life	Approx. 40,000 hours
Light intensity	20,000 lm
Weight	Approx. 10 kg
Dimensions (L x W x D in cm)	130 x 13 x 22
Remote control	Via the DMX interface
Color temperature	2,700 – 6,500 K (CRI value 95), controllable
Fuses	F 4 A H, 5 x 20 mm
Mains connection	Multi-voltage 90 – 230 V
Power consumption	Max. 4 A
Convection cooling	Yes
Ventilation openings	Two
Display	LCD display, 4 rows, 20 columns
Control element	Rotary switch with button
Connection	5-pin DMX plug and socket (in/out)
Subject to technical change. The specified data constitutes typical values that can be subject to fluctuations due to the tolerances of the components used.	

Unpacking the device and checking the scope of delivery

- Remove the device from the packaging.
- Keep the original packaging in case you need to return the product to Customer Service.
- Check the scope of delivery for correctness and completeness (see page 9).
- Ensure that all parts are undamaged.
- If any parts are incorrect or missing, contact the manufacturer and/or dealer immediately.

Commissioning the device

To commission the device, proceed as follows:

- Connect the mains cable to the device (see page 17).
- Connect the other end of the mains cable to a mains socket.
- Turn on the device at the main switch (see page 23).

Mounting and removing components of the device

IMPORTANT!

- The device can be damaged if external products are used.
- Use only original spare parts and accessories from the manufacturer.

Connecting and disconnecting the mains cable

To connect the mains cable, proceed as follows:

- Insert the plug of the mains cable (3) into the mains socket of the device (1).
- Secure the plug (3) with the union nut (2).
- Connect the mains cable to a mains socket.

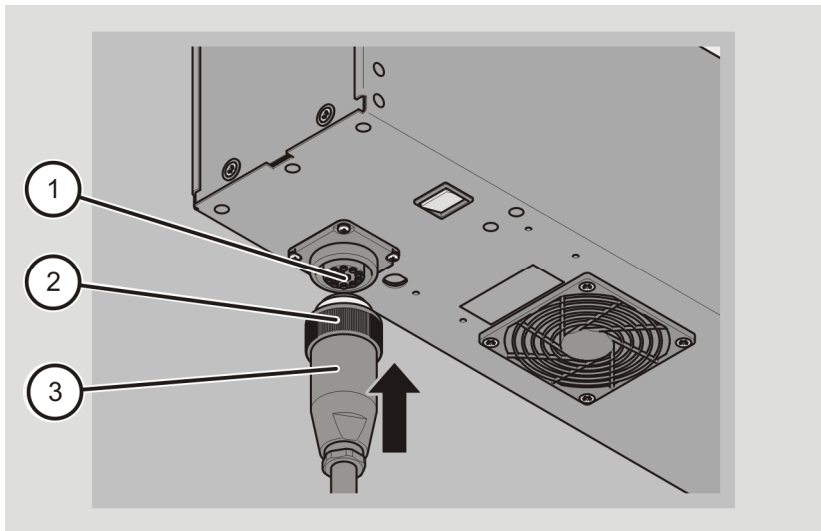

To remove the mains cable from the device, proceed as follows:

- Remove the mains cable from the mains socket.
- Loosen the union nut (2) completely.
- Remove the plug (3) from the mains socket (1).

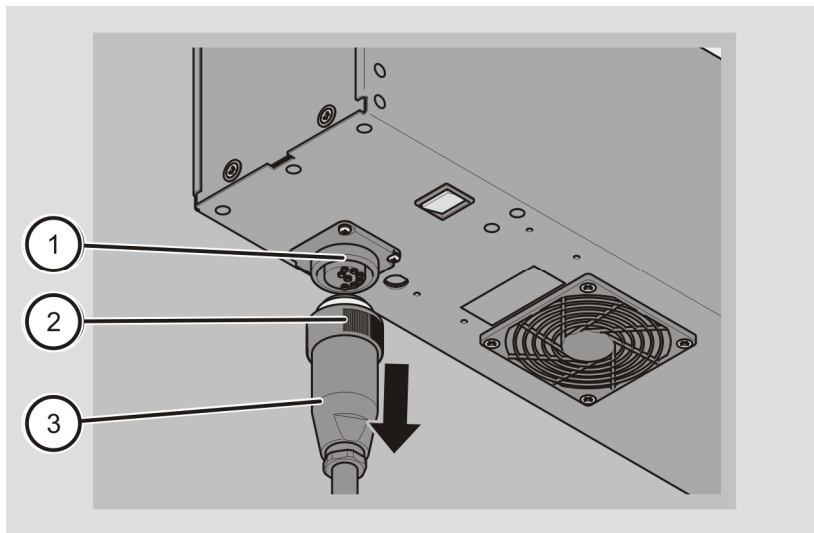

Mounting the device on/removing it from a stand

To mount the device on a stand, proceed as follows:

- Loosen the knurled screw (1).
- Make sure that you do not completely unscrew the knurled screw (1).
- Place the device on the stand (2) and tighten the knurled screw (1).

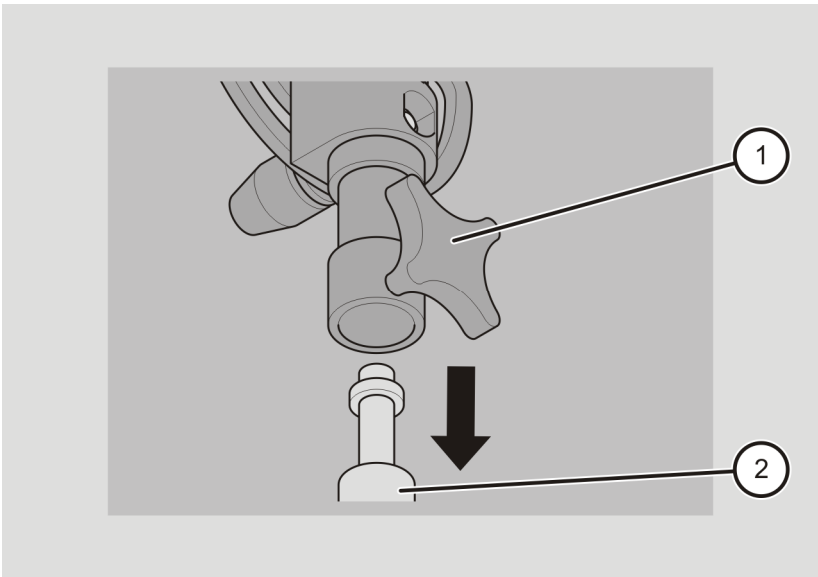

To remove the device from the stand, proceed as follows:

- Loosen the knurled screw (1).
- Remove the device from the stand (2).

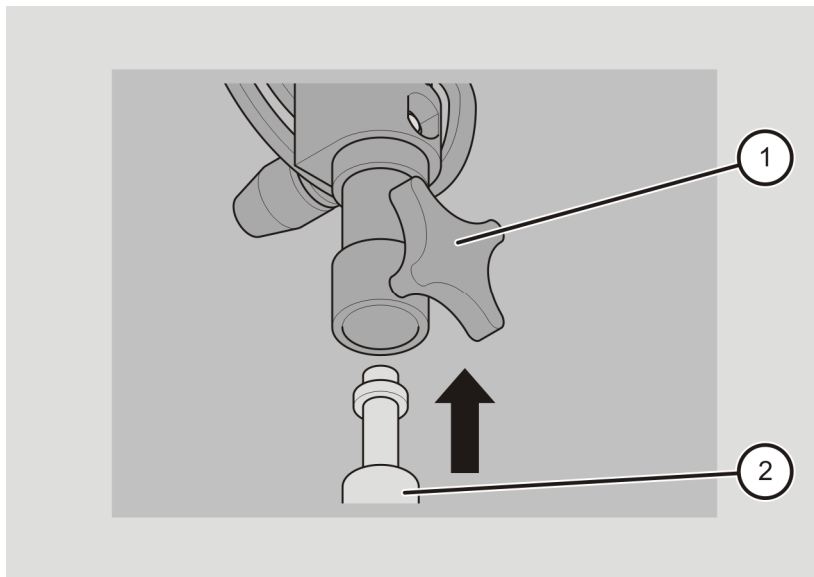

Connecting the device to and removing it from the DMX system

The DMX menu can be called only if the DMX plug is connected to the device. To connect the device to the DMX system, proceed as follows:

- Insert the DMX plug into the DMX connection socket (1).

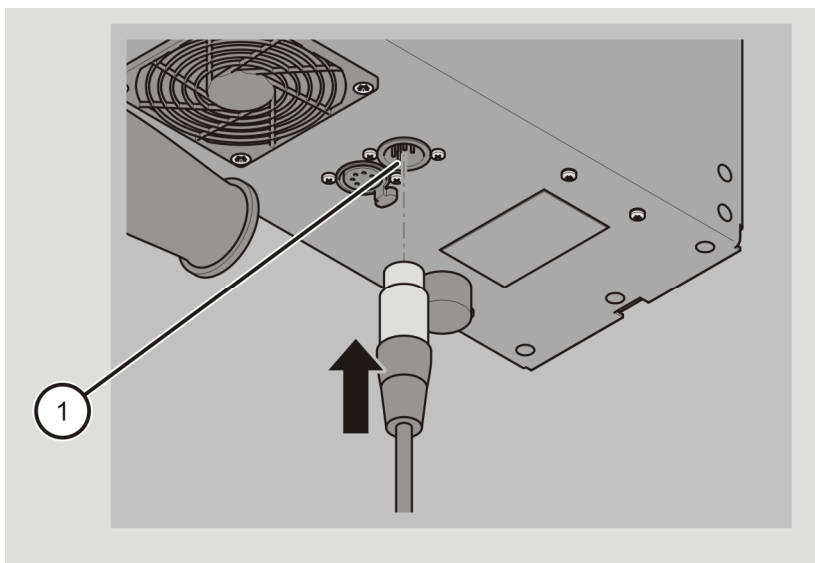

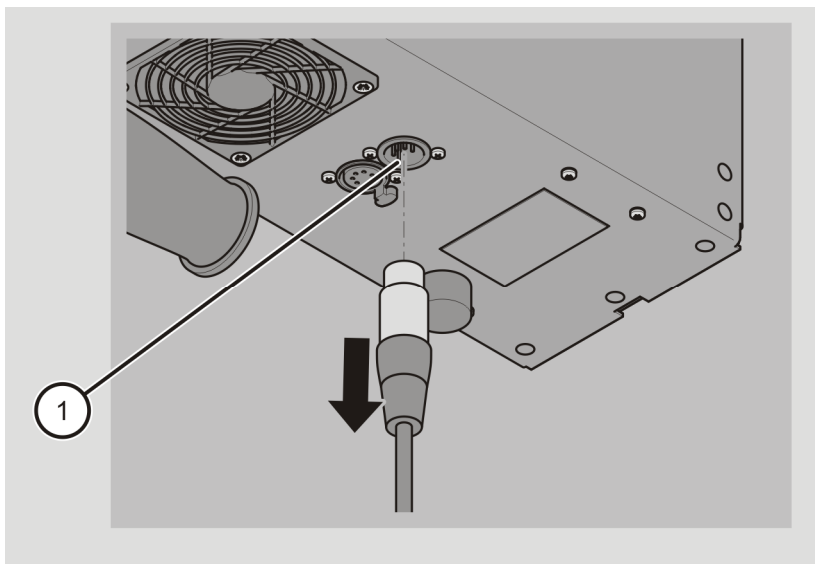

To remove the DMX plug from the device, proceed as follows:

- Remove the plug from the DMX mains socket (1).



Rotating and tilting the device

 CAUTION	
	<p>Crushing injuries can occur when loosening the locking lever.</p> <ul style="list-style-type: none">➤ To prevent twisting and tipping over, hold the device firmly with one hand while loosening the locking lever with the other.

When mounting the device onto a stand, the device can be rotated horizontally by 360° and tilted vertically by approx. 180°.

- To rotate the device horizontally, loosen the knurled screw.
- Rotate the device into the desired position and tighten the knurled screw.
- To tilt the device vertically, hold the device with one hand.
- Loosen the locking lever.
- Pivot the device into the desired position and tighten the locking lever.

Operating the device

Activating and deactivating the device

- Make sure the device is connected.
- To switch on the device, set the main switch (1) to the “I” position.
- To switch off the device, set the main switch (1) to the “0” position.

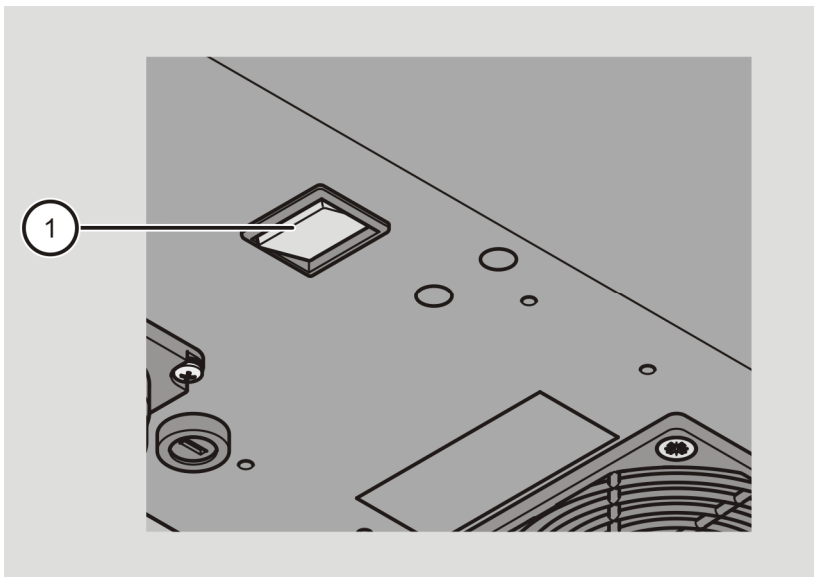

Adjusting settings on the device

The device has a Setup menu. The Setup menu consists of a Manual, System and DMX menu. The last menu used is saved at shutdown and displayed automatically at restart. This also applies if the device is used via a DMX console in the meantime. The menu active before the connection of the DMX console is displayed again after the DMX plug is removed. For further information on the DMX menu, see the “DMX menu” section on page 32.

The following figure shows the Setup menu.

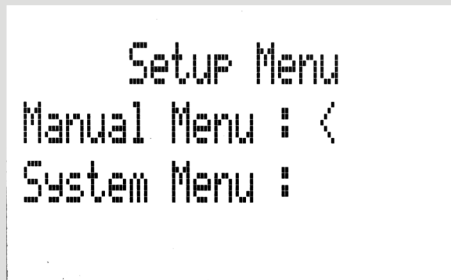

- | | |
|--------------|--|
| MANUAL MENU: | Switch LED on and off, set f-stop and color temperature |
| SYSTEM MENU: | Set background lighting, display serial number and version of the device |
| ARROW: | Marks the parameter/menu item to be selected |

Manual menu

To switch from the Setup menu to the MANUAL MENU sub-menu, proceed as follows:

- In the Setup menu, select the MANUAL MENU sub-menu with the rotary switch.
- Briefly press the rotary switch.

The MANUAL MENU sub-menu is displayed.

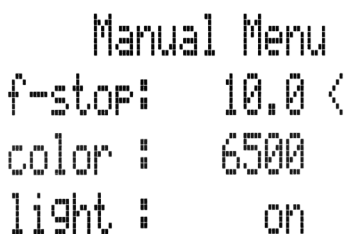

```
Manual Menu
f-stop:  10.0 <
color :   6500
light :    on
```

F-STOP: Set f-stop

COLOR: Set color temperature

LIGHT: Switch LED on and off

ARROW: Marks the parameter/menu item to be selected

- ❗ To switch from the Manual menu to the Setup menu, press and hold down the rotary switch.

Set f-stop

In the Manual menu, there are 9 f-stops to choose from (in 1/10 f-stop increments). To set the f-stop, proceed as follows:

- Select the F-STOP (1) with the rotary switch.

The last value saved is displayed

- To change the value, briefly press the rotary switch.

The f-stop (2) can now be changed.

- To increase it, turn the rotary switch clockwise.
- To decrease it, turn the rotary switch counterclockwise.
- To confirm the f-stop, press the rotary switch again.

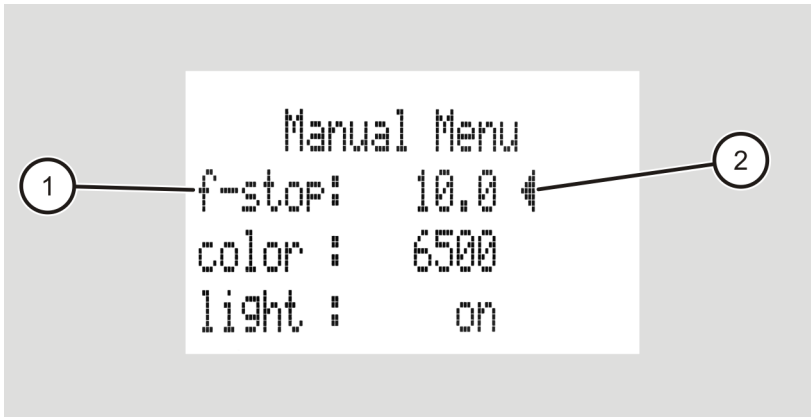

- ❗ The temperature of the LED is monitored by a temperature sensor. If the temperature is too high, the output is reduced to 10%. After cooling down, the output returns to the last value saved.

Set color temperature

In the Manual menu, the color temperature can be set in 50 K increments from 2,700 to 6,500 K. To set the color temperature, proceed as follows:

- Select the COLOR (1) with the rotary switch.

The last value saved is displayed

- To change the value, briefly press the rotary switch.

The color temperature (2) can now be changed.

- To increase it, turn the rotary switch clockwise.
- To decrease it, turn the rotary switch counterclockwise.
- To confirm the color temperature, press the rotary switch again.

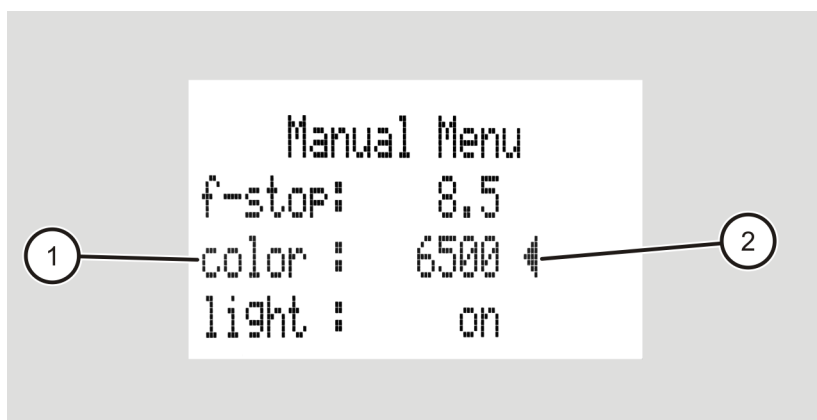

Switch LED on and off

In the Manual menu, the LED can be switched on and off. To activate the LED, proceed as follows:

- Select the LIGHT setting (1) with the rotary switch.
- To switch the LED on and off, briefly press the rotary switch.

If the LED is switched on, the ON status (2) is displayed.

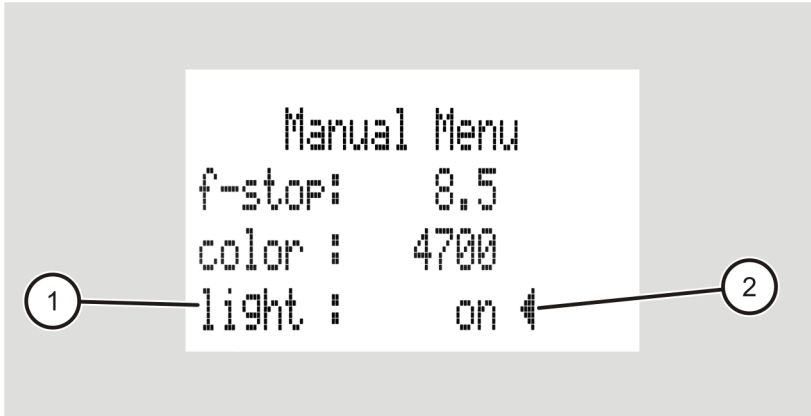

If the LED is switched off, the OFF status (3) is displayed.

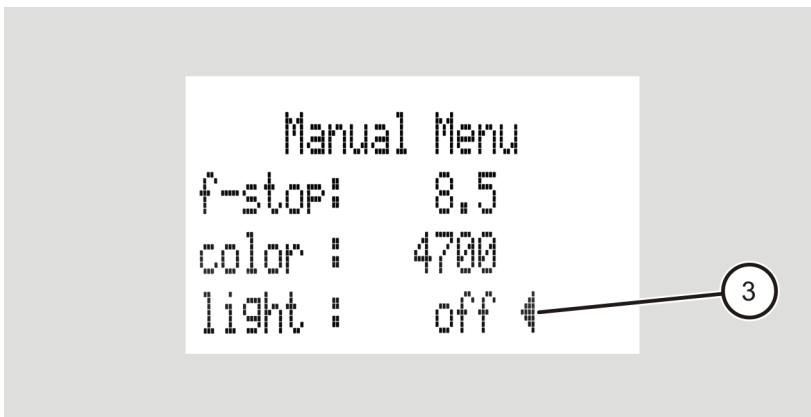

SYSTEM MENU

To switch from the Setup menu to the SYSTEM MENU sub-menu, proceed as follows:

- In the Setup menu, select the SYSTEM MENU sub-menu with the rotary switch.
- Briefly press the rotary switch.

The SYSTEM MENU sub-menu is displayed.

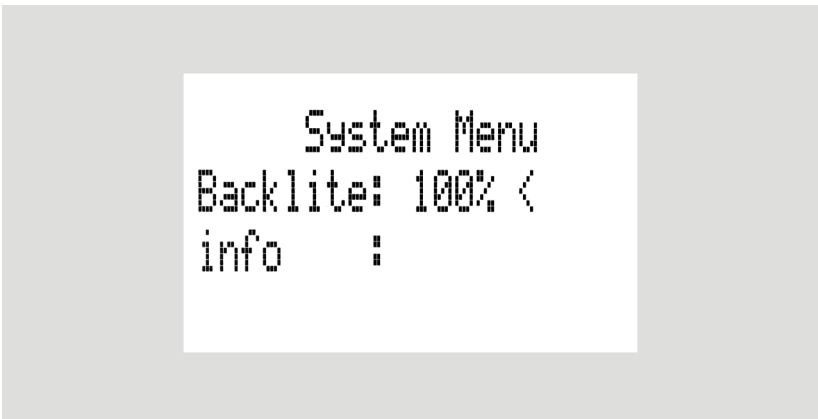

BACKLITE: Set the background lighting

INFO: The serial number and version of the device can be displayed

ARROW: Shows the setting/menu item to be selected

- ❶ To switch from the System menu to the Setup menu, press and hold down the rotary switch.

Setting the background lighting

The background lighting can be set in the System menu. To set the background lighting, proceed as follows:

- Select BACKLITE (1) with the rotary switch.
- To select BACKLITE (1), briefly press the rotary switch.

The value of the backlite (2) can now be changed.

- Turn on the corresponding lighting using the rotary switch.
- To confirm the setting, press the rotary switch again.

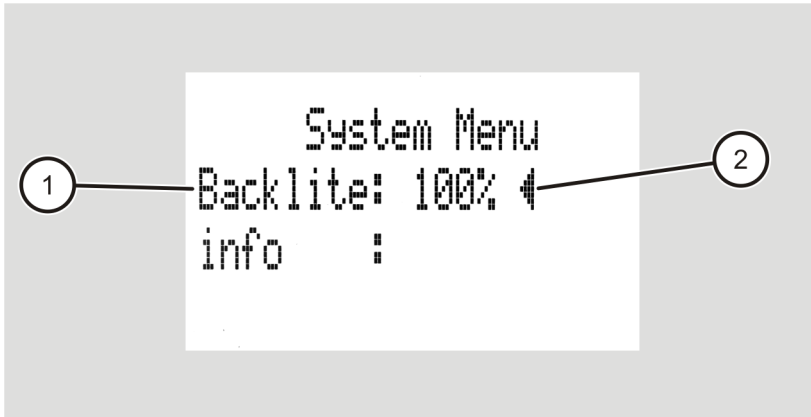

Displaying the serial number and version of the device

The serial number and version of the device can be displayed in the System menu. To display the serial number and version, proceed as follows:

- Select INFO (1) with the rotary switch.
- To display the version and serial number, press the rotary switch.

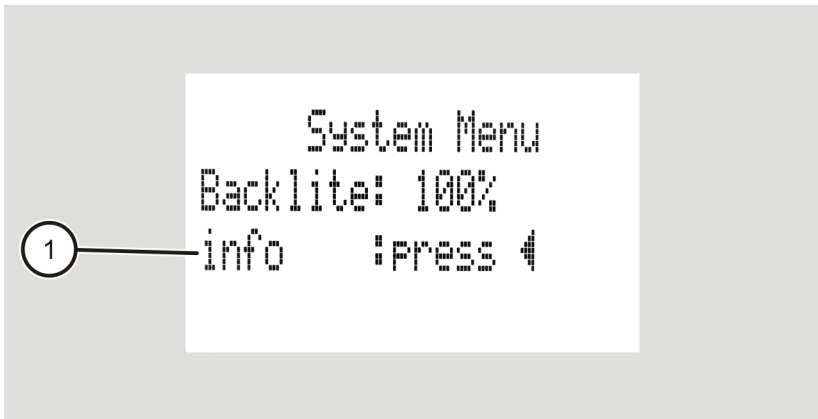

The serial number and version are displayed as shown below.

- To exit the INFO sub-menu, press the rotary switch.



DMX menu

The DMX menu can only be displayed if the DMX console is connected to the device. The DMX menu can be exited only by taking out the DMX plug.

In the DMX menu, DMX addresses can be set directly on the device for communication with the device using a DMX console. The f-stop and color temperature are set on the DMX console, and can be displayed in the DMX menu through two DMX channels (channel 1: f-stop, channel 2: color temperature).

The following figure shows the DMX menu.

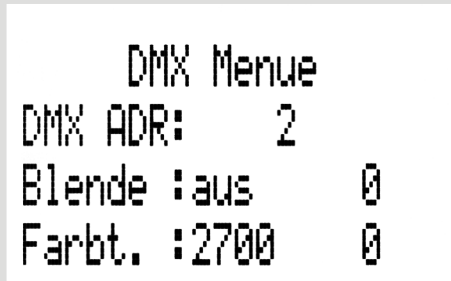

DMX ADDRESS: Set from 1 to a maximum of 511 addresses

F-STOP: Off–10.0: The f-stop is set from the DMX console
0–255: Display for the bit value sent from the DMX console

COLOR TEMPERATURE The color temperature is set from the DMX

- ❗ Additional information on the channels (1 and 2) on setting the f-stop and color temperature can be found in the instructions of the DMX console.

Setting addresses

Up to a maximum of 511 addresses can be set in the DMX menu. To set these addresses, proceed as follows:

- Select the corresponding DMX ADDRESS (1).
- To save the DMX address, hold the rotary switch down for longer than a second.

SAVE (2) is displayed. The DMX address is saved.

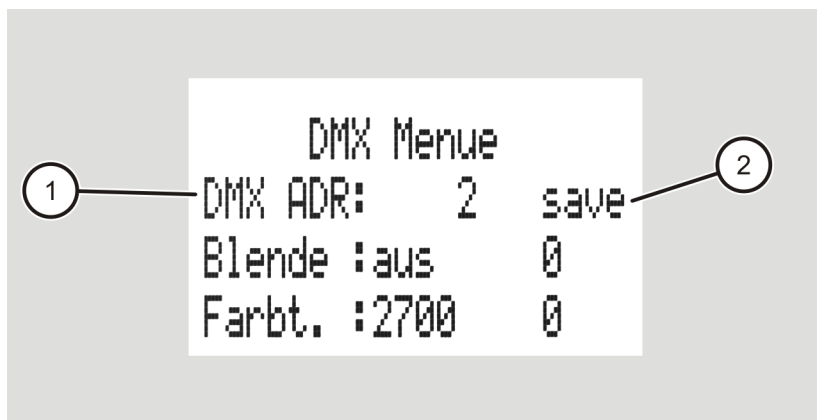

DMX f-stop setting

DMX VALUE	F-STOP	DMX VALUE	F-STOP
0-14	Off	135-137	6.0
15-17	2.0	138-140	6.1
18-20	2.1	141-143	6.2
21-23	2.2	144-146	6.3
24-26	2.3	147-149	6.4
27-29	2.4	150-152	6.5
30-32	2.5	153-155	6.6
33-35	2.6	156-158	6.7
36-38	2.7	159-161	6.8
39-41	2.8	162-164	6.9
42-44	2.9	165-167	7.0
45-47	3.0	168-170	7.1
48-50	3.1	171-173	7.2
51-53	3.2	174-176	7.3
54-56	3.3	177-179	7.4
57-59	3.4	180-182	7.5
60-62	3.5	183-185	7.6
63-65	3.6	186-188	7.7
66-68	3.7	189-191	7.8
69-71	3.8	192-194	7.9
72-74	3.9	195-197	8.0
75-77	4.0	198-200	8.1
78-80	4.1	201-203	8.2
81-83	4.2	204-206	8.3
84-86	4.3	207-209	8.4

DMX VALUE	F-STOP	DMX VALUE	F-STOP
87-89	4.4	210-212	8.5
90-92	4.5	213-215	8.6
93-95	4.6	216-218	8.7
96-98	4.7	219-221	8.8
99-101	4.8	222-224	8.9
102-104	4.9	225-227	9.0
105-107	5.0	228-230	9.1
108-110	5.1	231-233	9.2
111-113	5.2	234-236	9.3
114-116	5.3	237-239	9.4
117-119	5.4	240-242	9.5
120-122	5.5	243-245	9.6
123-125	5.6	246-248	9.7
126-128	5.7	249-251	9.8
129-131	5.8	252-254	9.9
132-134	5.9	255-255	10.0

DMX color setting

DMX VALUE	COLOR TEMPERATURE	DMX VALUE	COLOR TEMPERATURE
0-2	2700	117-119	4650
3-5	2750	120-122	4700
6-8	2800	123-125	4750
9-11	2850	126-128	4800
12-14	2900	129-131	4850
15-17	2950	132-134	4900
18-20	3000	135-137	4950
21-23	3050	138-140	5000
24-26	3100	141-143	5050
27-29	3150	144-146	5100
30-32	3200	147-149	5150
33-35	3250	150-152	5200
36-38	3300	153-155	5250
39-41	3350	156-158	5300
42-44	3400	159-161	5350
45-47	3450	162-164	5400
48-50	3500	165-167	5450
51-53	3550	168-170	5500
54-56	3600	171-173	5550
57-59	3650	174-176	5600
60-62	3700	177-179	5650
63-65	3750	180-182	5700
66-68	3800	183-185	5750
69-71	3850	186-188	5800
72-74	3900	189-191	5850

DMX VALUE	COLOR TEMPERATURE	DMX VALUE	COLOR TEMPERATURE
75-77	3950	192-194	5900
78-80	4000	195-197	5950
81-83	4050	198-200	6000
84-86	4100	201-203	6050
87-89	4150	204-206	6100
90-92	4200	207-209	6150
93-95	4250	210-212	6200
96-98	4300	213-215	6250
99-101	4350	216-218	6300
102-104	4400	219-221	6350
105-107	4450	222-242	6400
108-110	4500	225-227	6450
111-113	4450	228-225	6500
114-116	4600		

Transporting and storing the device

To transport and store the device, proceed as follows:

- Turn off the device at the main switch (see page 23).
- Remove the mains cable from the power mains.
- Remove the mains cable from the device (see page 17).
- Do not store the device in locations exposed to heat, moisture, frost or cold.
- Cover the device.

Servicing the device

Caring for and cleaning the device

To guarantee electrical safety, the device must be cleaned regularly. To clean it, proceed as follows.

- Regularly clean the outside of the device with a dry cloth.

Regular inspection

National safety regulations – e.g. the Industrial Safety Act (BetrSichV) and DGUV Regulation 3 (formerly BGV A3) in Germany – require inspection and maintenance of electrical devices at regular intervals. The operating safety of devices and accessories must be checked regularly. An annual inspection of the devices should be carried out for the safety of the users and to retain the value of the device.

The regulations specified above (BetrSichV and DGUV Regulation 3 (formerly BGV A3) apply to Germany; please observe the corresponding local regulations in your country.

Replacing a defective fuse

To replace the defective fuse, proceed as follows:

- Switch off the device at the main switch (1).
- Pull out the mains cable (2).

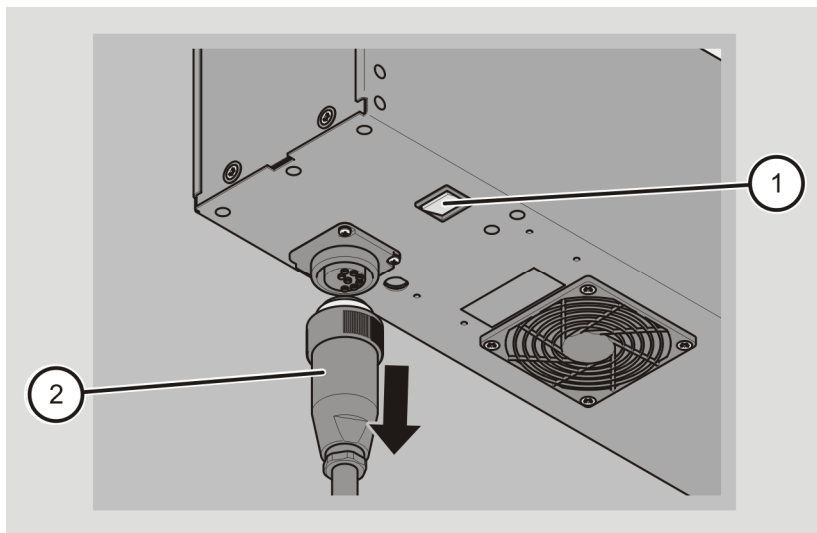

- Open the fuse holder (2) with a small screwdriver (3) and pull it out.
- Remove the defective fuse (1).
- Insert the spare fuse into the fuse holder (2).
- Close the fuse holder (2).

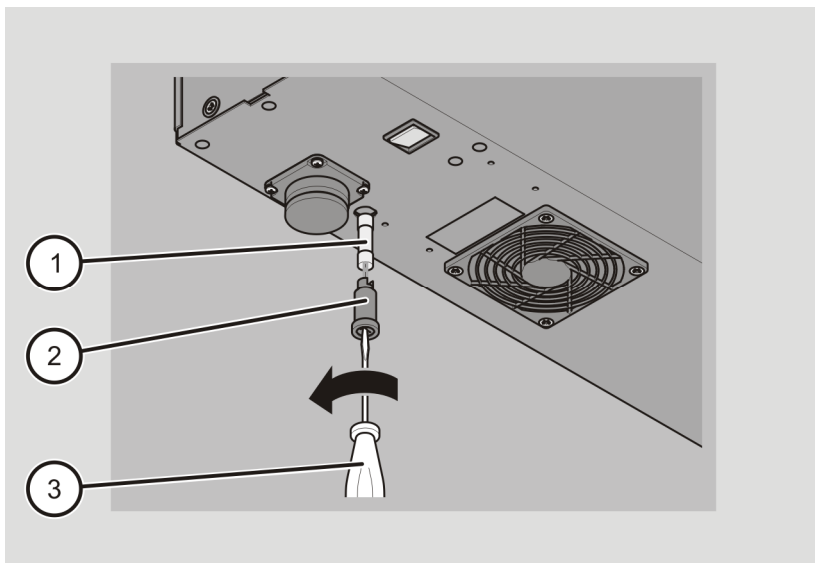

Disposing of the device and packaging

In Germany

- Dispose of the packaging of the device, separated according to material. Use local options for collecting paper, cardboard and lightweight packaging.
- Dispose of the device and accessories separately from domestic waste. Information regarding collection points that accept old devices free of charge can be obtained from your municipal authority.



Outside of Germany

- Dispose of the device and packaging according to the regulations at the place of use.

Accessories

Designation	Article number
Gates for Lightbar 130 LED	9518411

Warranty provisions

In Germany

The warranty provisions can be found in our general terms and conditions for business on our website: www.hensel.de

Outside of Germany

The warranty provisions of the dealer from which you have purchased the device apply.

Limitation of liability

We are not liable for equipment or property damage, or personal injury arising from improper use of the device that is inconsistent with the information provided in the user manual. We are also not liable for consequential damages (such as production or income losses, etc.) that may be caused by a defect in or malfunction of our device.

Returning a product to Customer Service

As soon as you discover damage to the device, proceed as follows:

- Send the device in its original packaging with a precise description of the defect to the following address for repair:

HENSEL-VISIT GmbH & Co. KG
Customer Service Department
Robert-Bunsen-Str. 3
D-97076 Würzburg, Germany

Phone: +49 (0) 931-27881-0

Our Customer Service addresses within and outside of Germany can be found at:
www.hensel.de

